

**from \$64,787**

\$1,030 per m<sup>2</sup>

**3 rooms, 62.9 m<sup>2</sup>**

**7-15, 17-26 out of 26**

Angisa 1st lane, 35b

Block B



**from \$67,798**

\$1,090 per m<sup>2</sup>

**3 rooms, 62.2 m<sup>2</sup>**

**9-12 out of 26**

Angisa 1st lane, 35b

Block A



**from \$74,694**

\$1,180 per m<sup>2</sup>

**3 rooms, 63.3 m<sup>2</sup>**

**12-26 out of 26**

Angisa 1st lane, 35b

Block B



**from \$75,383**

\$1,210 per m<sup>2</sup>

**3 rooms, 62.3 m<sup>2</sup>**

**13-15, 17-26 out of 26**

Angisa 1st lane, 35b

Block B



**from \$75,867**

\$1,210 per m<sup>2</sup>

**3 rooms, 62.7 m<sup>2</sup>**

**13, 14, 16-26 out of 26**

Angisa 1st lane, 35b

Block A



**from \$77,290**

\$1,180 per m<sup>2</sup>

**3 rooms, 65.5 m<sup>2</sup>**

**12-26 out of 26**

Angisa 1st lane, 35b

Block B



**from \$77,996**

\$1,240 per m<sup>2</sup>

**3 rooms, 62.9 m<sup>2</sup>**

**14-26 out of 26**

Angisa 1st lane, 35b

Block A



**from \$80,600**

\$1,240 per m<sup>2</sup>

**3 rooms, 65 m<sup>2</sup>**

**14-16, 18, 20-26 out  
of 26**

Angisa 1st lane, 35b  
Block A





**from \$82,336**

\$1,660 per m<sup>2</sup>

**3 rooms, 49.6 m<sup>2</sup>**

**28 out of 26**

Angisa 1st lane, 35b

Block B



**from \$82,502**

\$1,660 per m<sup>2</sup>

**3 rooms, 49.7 m<sup>2</sup>**

**28 out of 26**

Angisa 1st lane, 35b

Block B



**from \$82,522**

\$1,210 per m<sup>2</sup>

**3 rooms, 68.2 m<sup>2</sup>**

**13, 14, 17-26 out of 26**

Angisa 1st lane, 35b

Block A

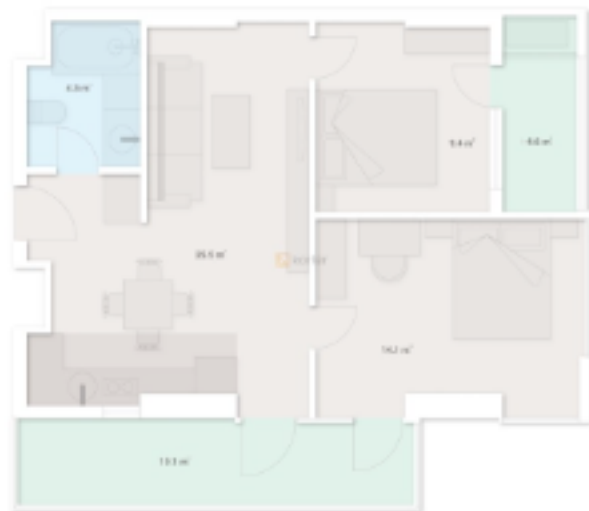

**from \$98,134**

\$1,390 per m<sup>2</sup>

**3 rooms, 70.6 m<sup>2</sup>**

**19-26 out of 26**

Angisa 1st lane, 35b  
Block B



**from \$115,404**

\$1,630 per m<sup>2</sup>

**3 rooms, 70.8 m<sup>2</sup>**

**27 out of 26**

Angisa 1st lane, 35b

Block B



**from \$115,567**

\$1,630 per m<sup>2</sup>

**3 rooms, 70.9 m<sup>2</sup>**

**27 out of 26**

Angisa 1st lane, 35b

Block B



**from \$127,156**

\$1,660 per m<sup>2</sup>

**3 rooms, 76.6 m<sup>2</sup>**

**28 out of 26**

Angisa 1st lane, 35b

Block B



**from \$135,456**

\$1,660 per m<sup>2</sup>

**3 rooms, 81.6 m<sup>2</sup>**

**28 out of 26**

Angisa 1st lane, 35b

Block B





**from \$168,053**

\$1,630 per m<sup>2</sup>

**3 rooms, 103.1 m<sup>2</sup>**

**27 out of 26**

Angisa 1st lane, 35b

Block B



**from \$168,542**

\$1,630 per m<sup>2</sup>

**3 rooms, 103.4 m<sup>2</sup>**

**27 out of 26**

Angisa 1st lane, 35b

Block B

